

UBP80

UNIVERSAL Power clamps



U	B	P	8	0	N	N	E
1	2	3	4	5	6		

1 Series	2 Version	3 Size
<p>UB = UNIVERSAL power clamps fully adjustable opening angle: 0° to 135° Max The opening angle range may vary according to the arm position and style</p>	<p>P = Pneumatic-standard</p>	<p>80 = Ø 80 mm</p>

4 Arm position	5 Arm style	6 Sensor
<p>V = 90° O = 180° N = No arm</p>	<p>C = Central, 20 mm offset D = Right, 20 mm offset S = Left, 20 mm offset E = Central, 45 mm offset F = Right, 45 mm offset L = Left, 45 mm offset N = No arm X = Central, oversized dowel holes Ø 8 H7, 20 mm offset Y = Right, oversized dowel holes Ø 8 H7, 20 mm offset Z = Left, oversized dowel holes Ø 8 H7, 20 mm offset</p>	<p>N = No sensor (with protection plate) E = Electronic sensor with M12 swivel connector</p>

Double arm version available
UBP80ODPE - UBP80VDPE

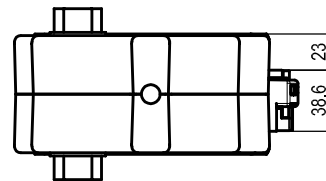
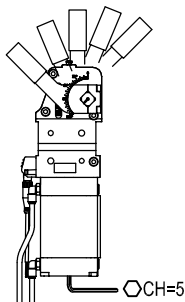
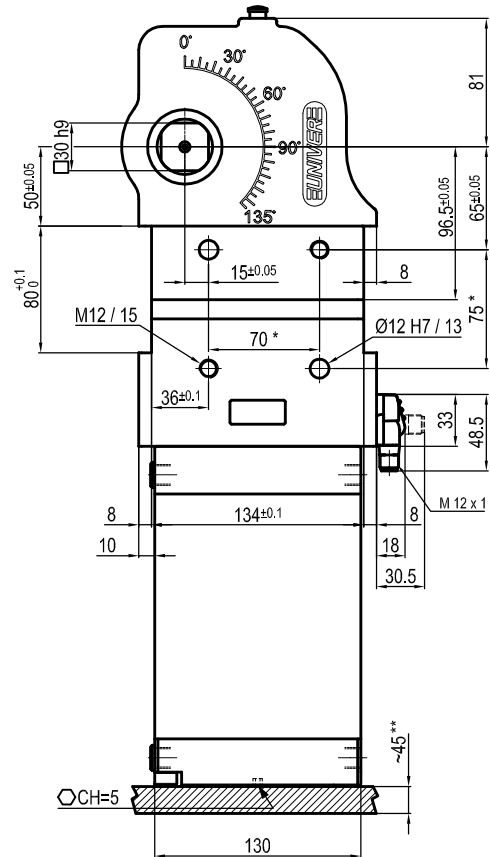
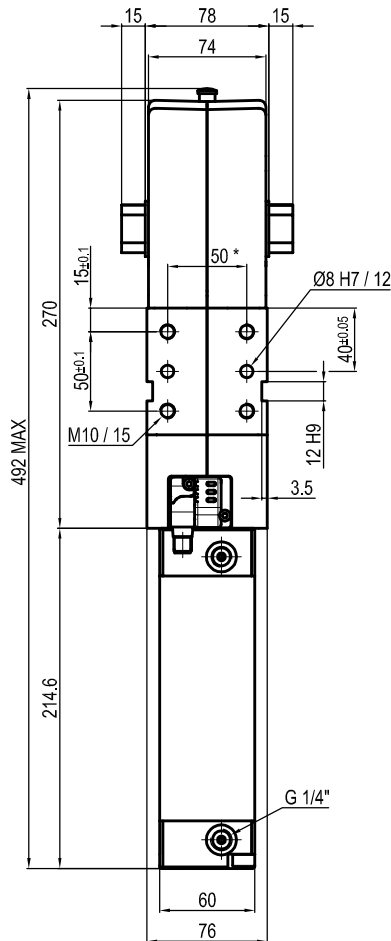

Bore Ø	Holding moment	Clamping moment	Weight (Clamping arm not included)
80 mm	4000 Nm	1100 Nm	9.3 Kg

Min./Max. operating pressure: **0,4 / 0,6 MPa**

Operating temperature: **5° + 45° C**

Opening angle: **adjustable**

Without arm

Electronic sensor with M12 swivel connector that can be orientated at 0° or 90°

Supply voltage: 10÷30 Vdc

IP code: **IP 65**

Pneumatic ports on both sides

* : TOLERANCE BETWEEN DOWELS ± 0.02, TO SCREW HOLES ± 0.1

** : AREA TO ACCESS ANGLE ADJUSTMENT

Subject to technical modifications without notice

UNIVERSAL Pneumatic clamp

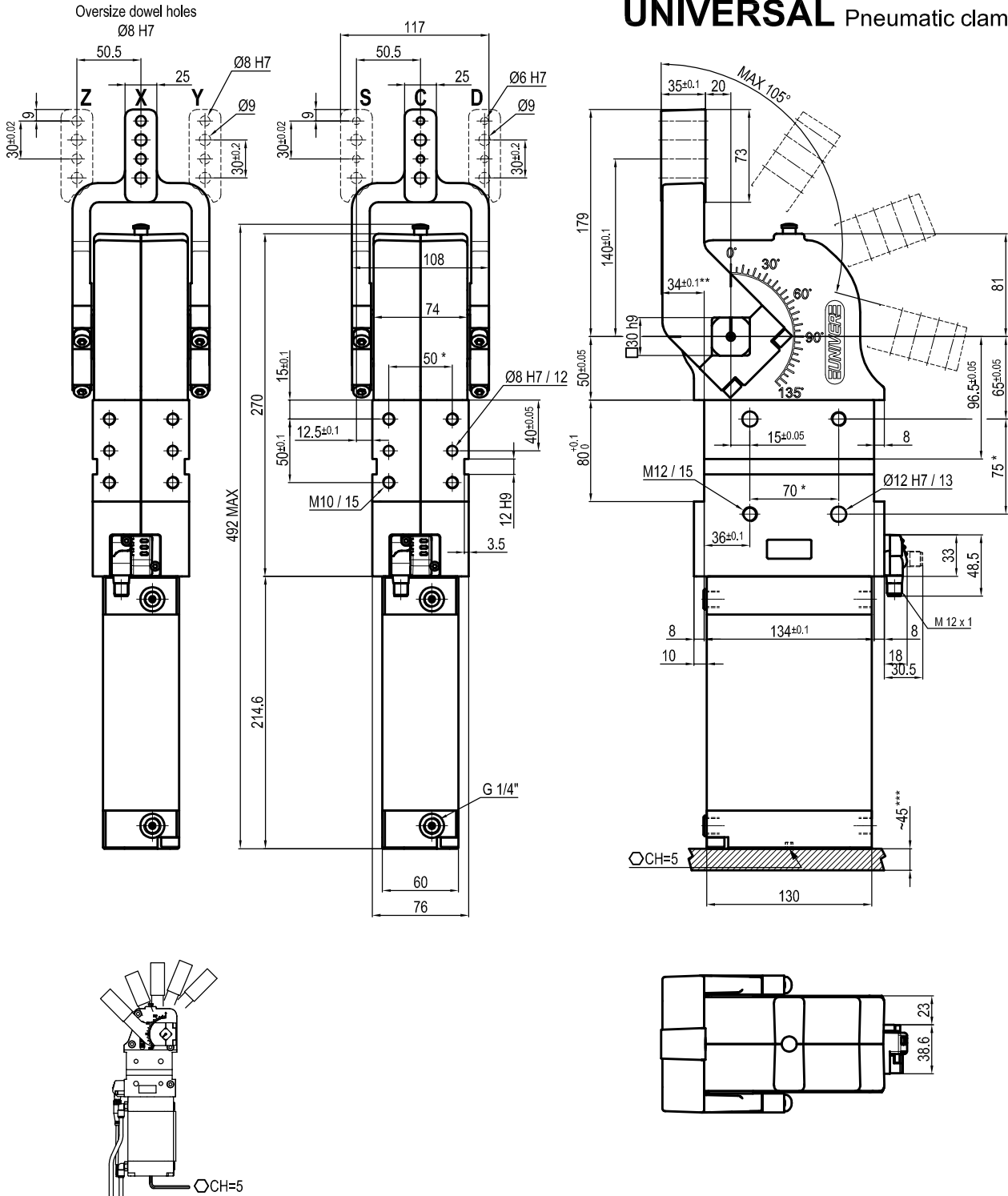

Bore Ø	Holding moment	Clamping moment	Weight (Clamping arm not included)
80 mm	4000 Nm	1100 Nm	9.3 Kg

Min./Max. operating pressure: **0,4 / 0,6 MPa**
 Operating temperature: **5° + 45° C**
 Opening angle: **adjustable from 0° to 105°**
 Horizontal arm mount position
 Electronic sensor with M12 swivel connector that can be orientated at 0° or 90°
 Supply voltage: 10÷30 Vdc
 IP code: **IP 65**
 Pneumatic ports on both sides

* : TOLERANCE BETWEEN DOWELS ± 0.02, TO SCREW HOLES ± 0.1
 ** : TOLERANCE AT 80 mm FROM PIVOT POINT
 *** : AREA TO ACCESS ANGLE ADJUSTMENT.

Subject to technical modifications without notice

UNIVERSAL Pneumatic clamp

arm at 45 mm from pivot point (arm style E-L-F)

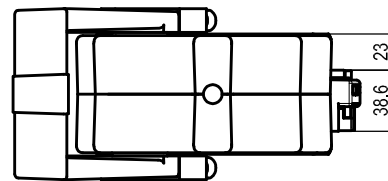
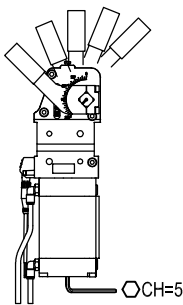
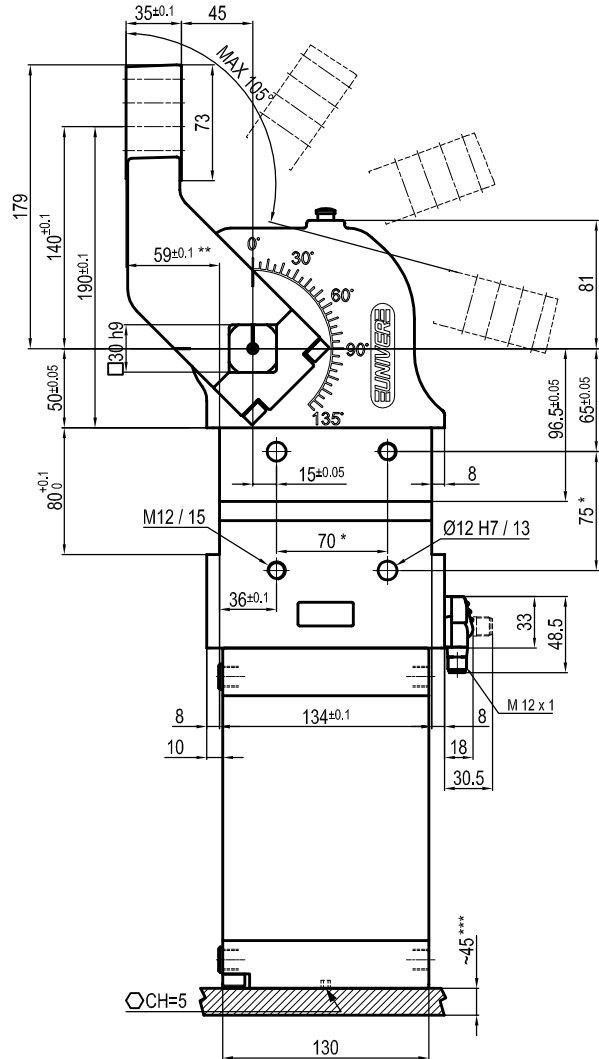
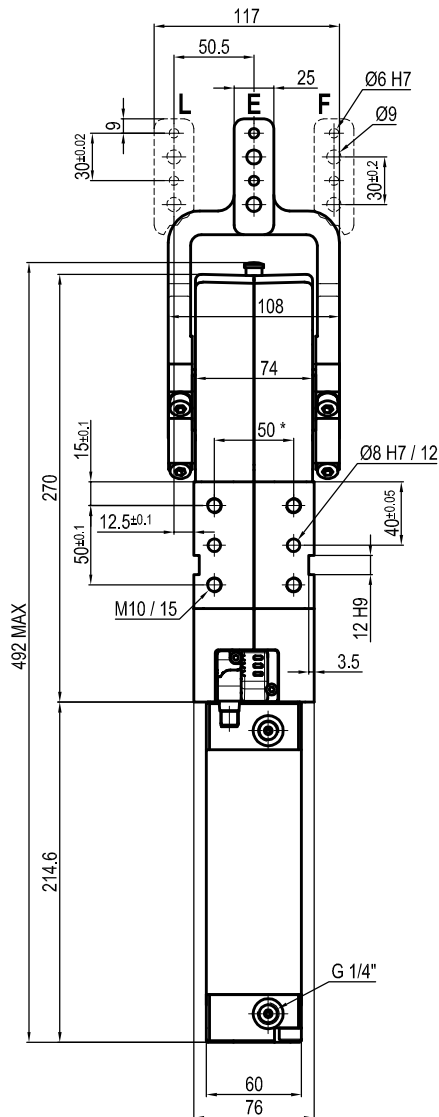

Bore Ø	Holding moment	Clamping moment	Weight (Clamping arm not included)
80 mm	4000 Nm	1100 Nm	9.3 Kg

Min./Max. operating pressure: **0,4 / 0,6 MPa**

Operating temperature: **5° + 45° C**

Opening angle: **adjustable from 0° to 105°**

Horizontal arm mount position

Electronic sensor with M12 swivel connector that can be orientated at 0° or 90°

Supply voltage: 10÷30 Vdc

IP code: **IP 65**

Pneumatic ports on both sides

* : TOLERANCE BETWEEN DOWELS ± 0.02, TO SCREW HOLES ± 0.1

** : TOLERANCE AT 80 mm FROM PIVOT POINT

*** : AREA TO ACCES ANGLE ADJUSTMENT

Subject to technical modifications without notice

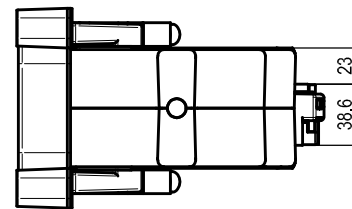
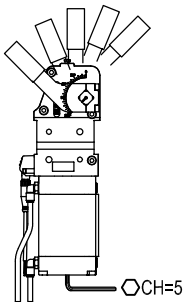
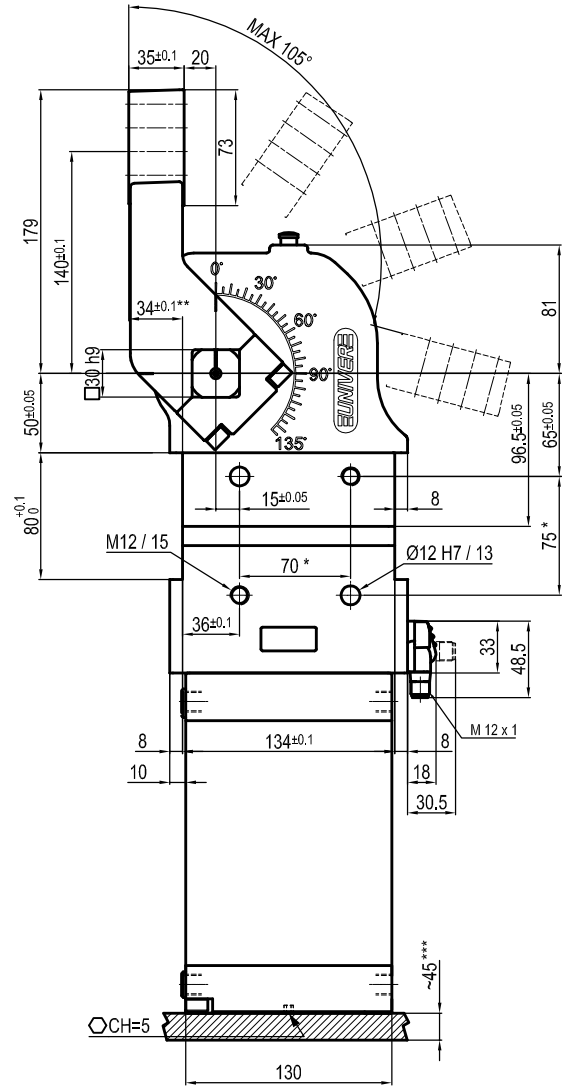
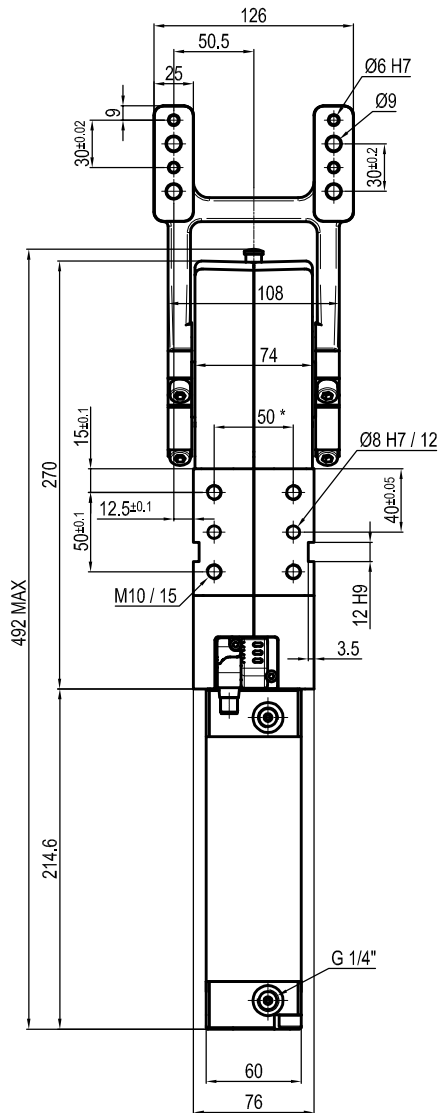

Bore Ø	Holding moment	Clamping moment	Weight (Clamping arm not included)
80 mm	4000 Nm	1100 Nm	9.3 Kg

Min./Max. operating pressure: **0,4 / 0,6 MPa**

Operating temperature: **5° + 45° C**

Opening angle: **adjustable from 0° to 105°**

Horizontal arm mount position

Electronic sensor with M12 swivel connector that can be orientated at 0° or 90°

Supply voltage: 10÷30 Vdc

IP code: **IP 65**

Pneumatic ports on both sides

* : TOLERANCE BETWEEN DOWELS ± 0.02, TO SCREW HOLES ± 0.1

** : TOLERANCE AT 80 mm FROM PIVOT POINT

*** : AREA TO ACCESS ANGLE ADJUSTMENT.

Subject to technical modifications without notice

UNIVERSAL Pneumatic clamp

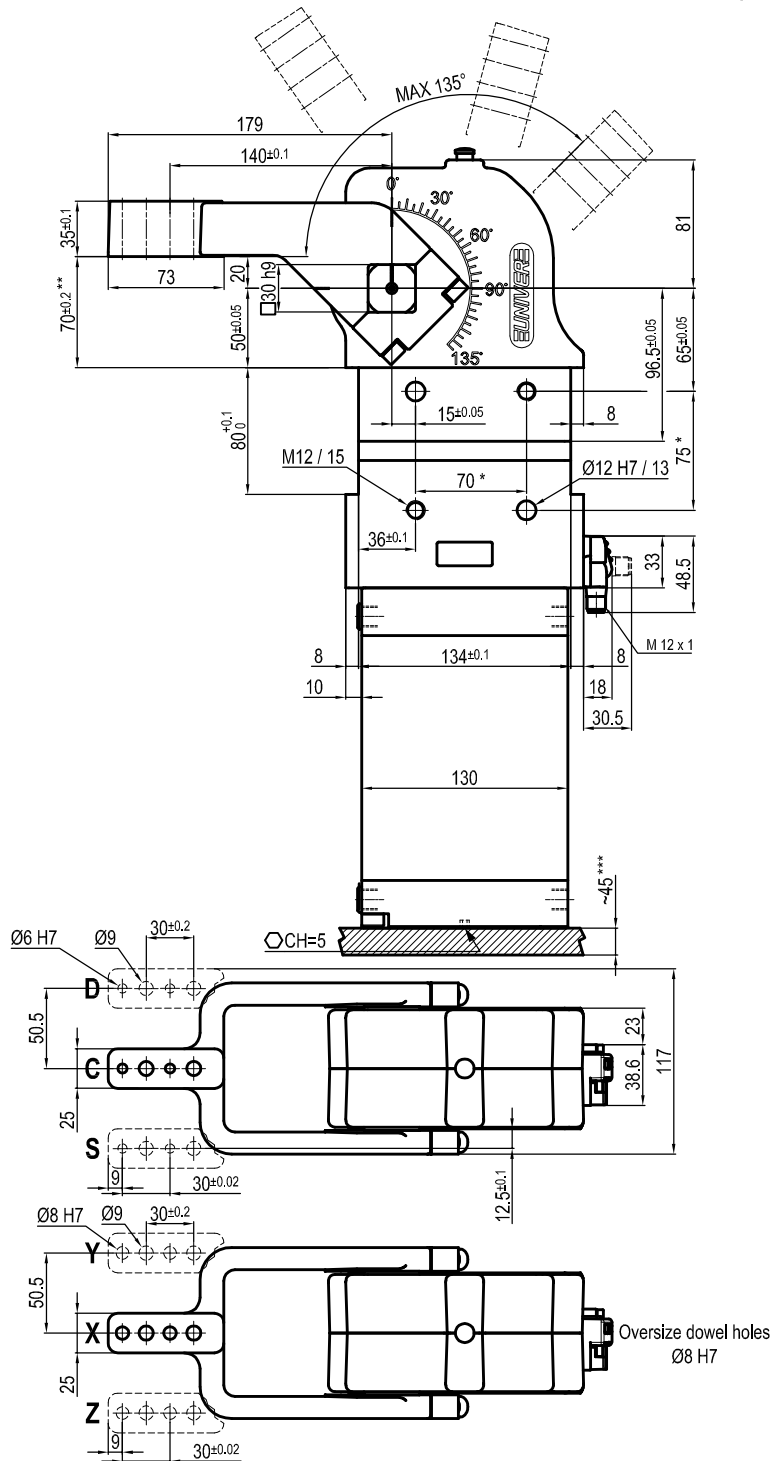
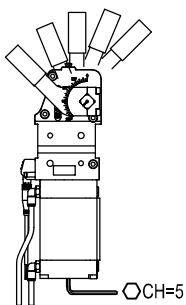
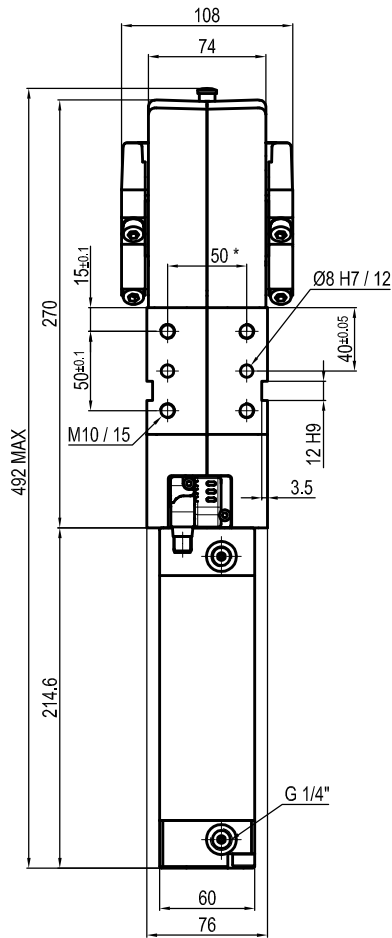

Bore Ø	Holding moment	Clamping moment	Weight (Clamping arm not included)
80 mm	4000 Nm	1100 Nm	9.3 Kg

Min./Max. operating pressure: **0,4 / 0,6 MPa**

Operating temperature: **5° + 45° C**

Opening angle: **adjustable from 0° to 135°**

Vertical arm mount position

Electronic sensor with M12 swivel connector that can be orientated at 0° or 90°

Supply voltage: 10÷30 Vdc

IP code: **IP 65**

Pneumatic ports on both sides

* : TOLERANCE BETWEEN DOWELS ± 0.02, TO SCREW HOLES ± 0.1

** : TOLERANCE AT 80 mm FROM PIVOT POINT

*** : AREA TO ACCESS ANGLE ADJUSTMENT.

Subject to technical modifications without notice

UNIVERSAL Pneumatic clamp arm at 45 mm from pivot point (arm style E-L-F)

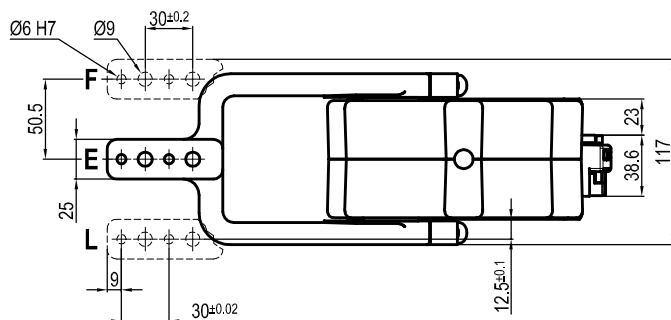
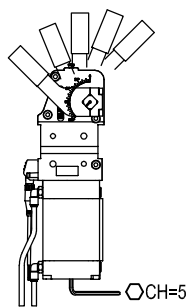
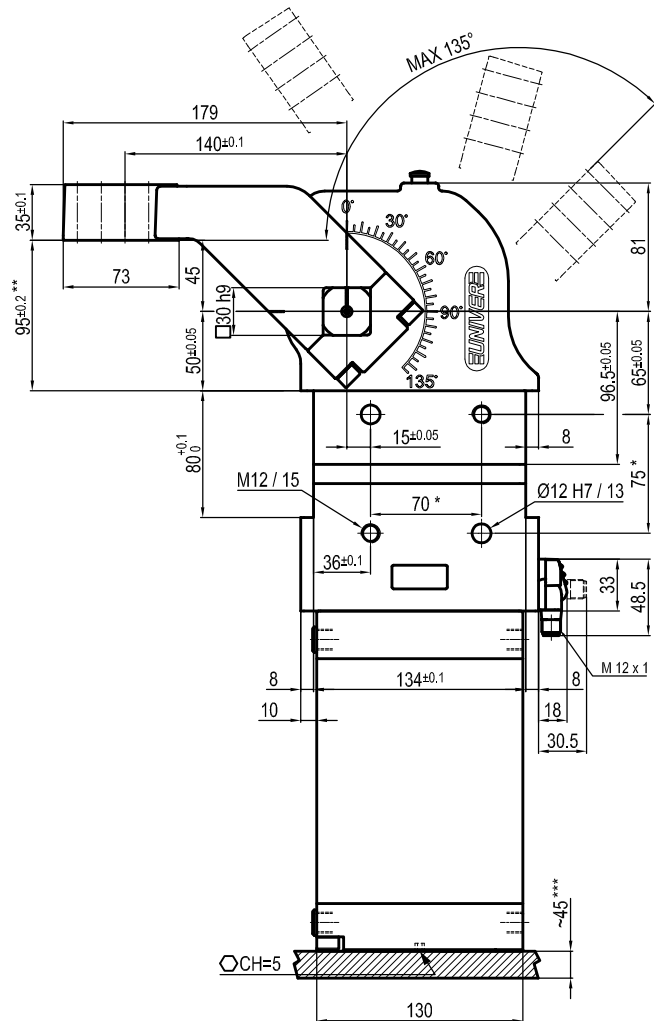
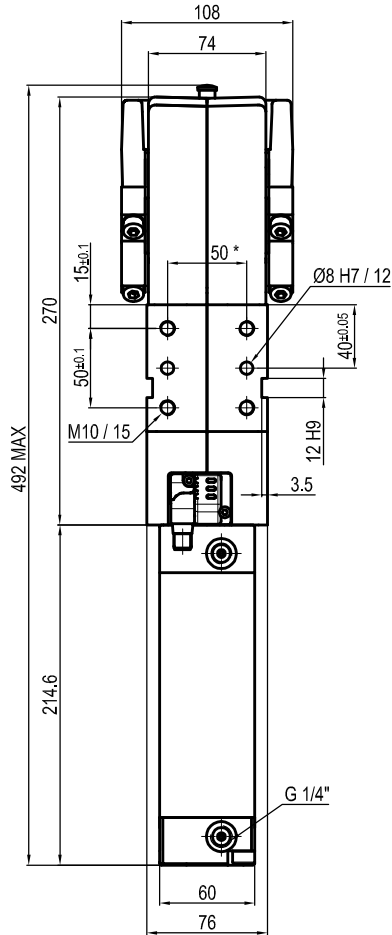

Bore Ø	Holding moment	Clamping moment	Weight (Clamping arm not included)
80 mm	4000 Nm	1100 Nm	9.3 Kg

Min./Max. operating pressure: **0,4 / 0,6 MPa**

Operating temperature: **5° + 45° C**

Opening angle: **adjustable from 0° to 135°**

Vertical arm mount position

Electronic sensor with M12 swivel connector that can be orientated at 0° or 90°

Supply voltage: 10÷30 Vdc

IP code: **IP 65**

Pneumatic ports on both sides

* : TOLERANCE BETWEEN DOWELS ± 0.02, TO SCREW HOLES ± 0.1

** : TOLERANCE AT 80 mm FROM PIVOT POINT

*** : AREA TO ACCES ANGLE ADJUSTMENT

Subject to technical modifications without notice

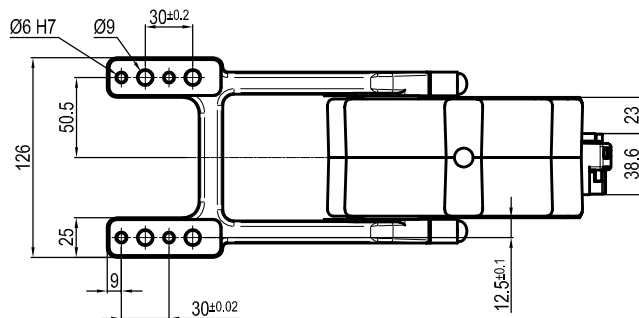
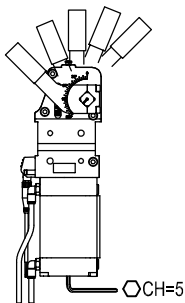
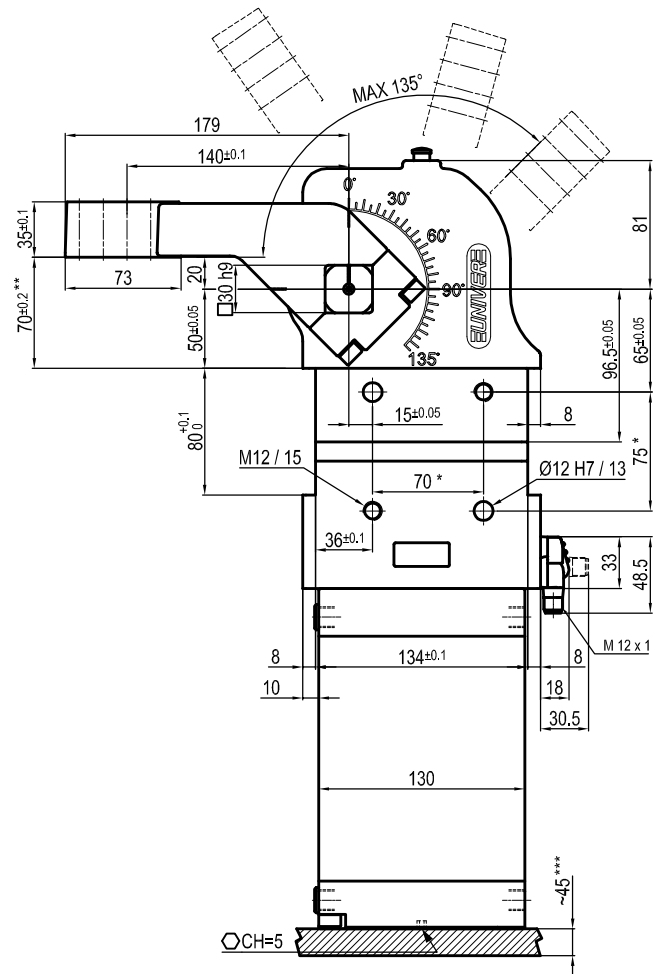
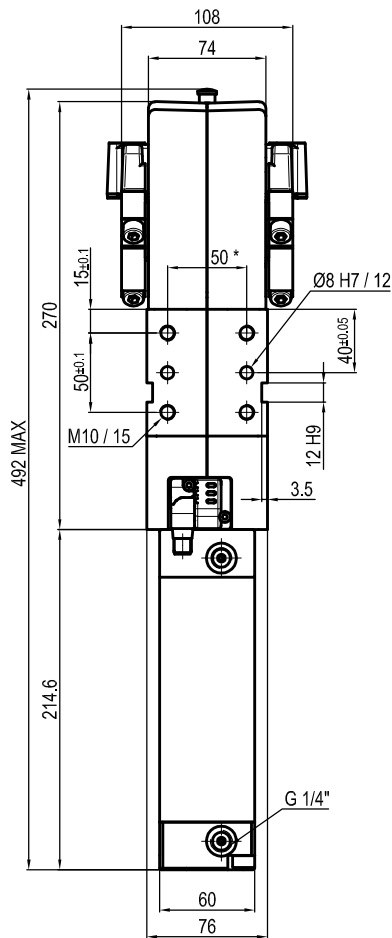

Bore Ø	Holding moment	Clamping moment	Weight (Clamping arm not included)
80 mm	4000 Nm	1100 Nm	9.3 Kg

Min./Max. operating pressure: **0,4 / 0,6 MPa**

Operating temperature: **5° + 45° C**

Opening angle: **adjustable from 0° to 135°**

Vertical arm mount position

Electronic sensor with M12 swivel connector that can be orientated at 0° or 90°

Supply voltage: 10÷30 Vdc

IP code: **IP 65**

Pneumatic ports on both sides

* : TOLERANCE BETWEEN DOWELS ± 0.02, TO SCREW HOLES ± 0.1

** : TOLERANCE AT 80 mm FROM PIVOT POINT

*** : AREA TO ACCESS ANGLE ADJUSTMENT.

Subject to technical modifications without notice