

IBM40

UNIVERSAL Power clamps



I	B	M	4	0	V	E	E
1	2	3	4	5	6		

<p>1 Series</p> <p>IB = UNIVERSAL power clamps fully adjustable opening angle: 0° to 125° Max interchangeable with 50 and 63 sizes The opening angle range may vary according to the arm position and style</p>	<p>2 Version</p> <p>M = Pneumatic with manual lever</p>	<p>3 Size</p> <p>40 = Ø 40 mm</p>
--	---	---

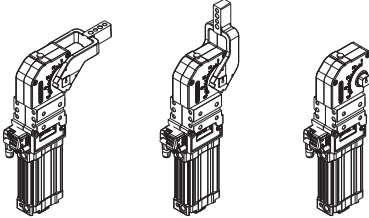
<p>4 Arm position</p> <p>V = 90° O = 180° N = No arm</p> 	<p>5 Arm style</p> <p>C = Central, 15 mm offset (standard) D = Right, 15 mm offset (standard) S = Left, 15 mm offset (standard) E = Central, 45 mm offset F = Right, 45 mm offset L = Left, 45 mm offset N = No arm</p>	<p>6 Sensor</p> <p>N = No sensor (with protection plate) E = Electronic sensor with M12 swivel connector</p>
--	---	--

UNIVERSAL Pneumatic power clamp Ø50 / Ø63 mm sizes compatible

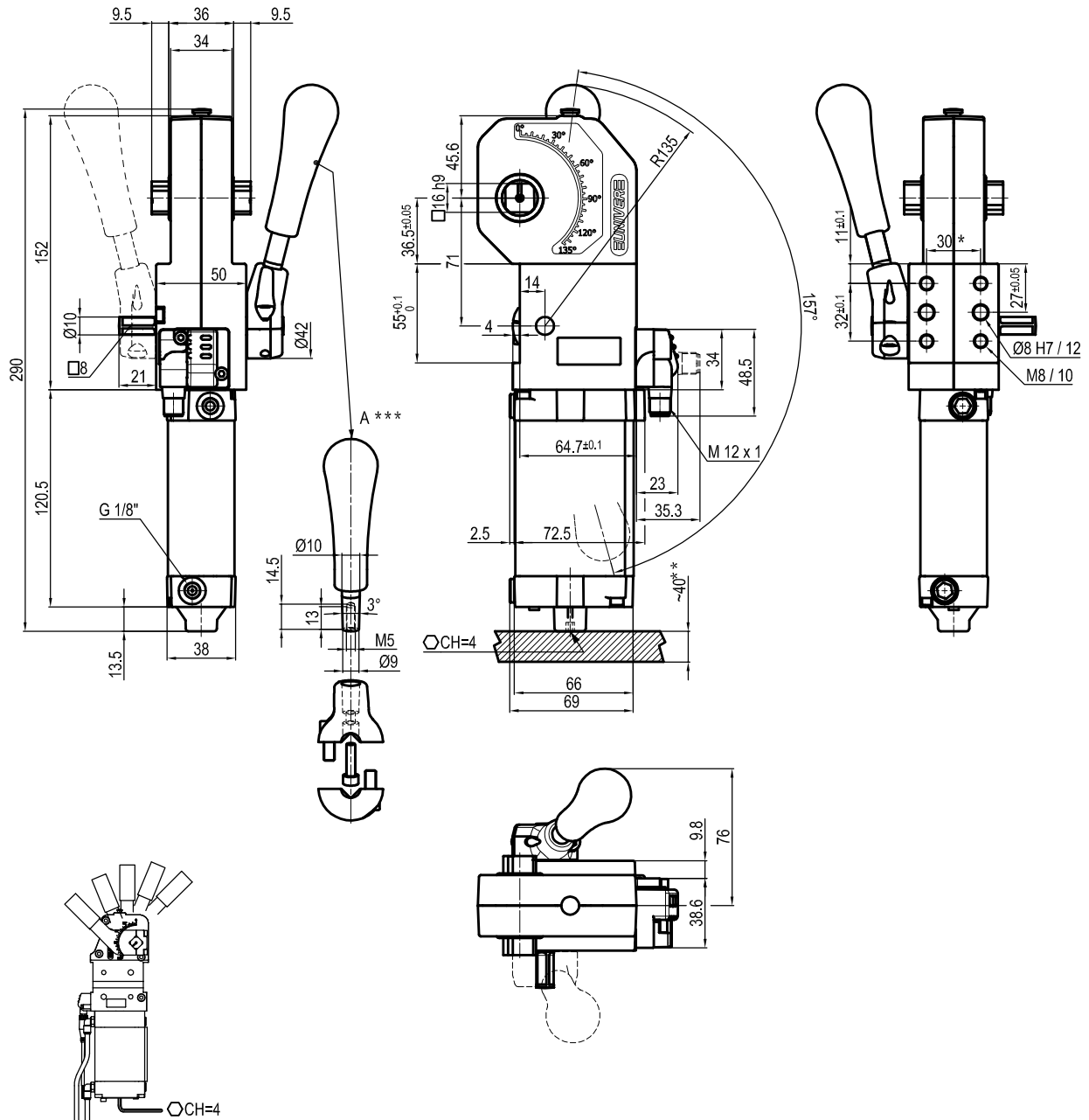

Bore Ø	Holding moment	Clamping moment	Weight (Clamping arm not included)
40 mm	600 Nm	170 Nm	2.1 Kg

Min./Max. operating pressure: **0,4 / 0,6 MPa**

Operating temperature: **5° + 45° C**

Opening angle: **adjustable**

Without arm

Electronic sensor with M12 swivel connector that can be orientated at 0° or 90°

Supply voltage: 10±30 Vdc

IP code: **IP 65**

Pneumatic ports on both sides

* : TOLERANCE BETWEEN DOWELS ± 0.02, TO SCREW HOLES ± 0.1

** : AREA TO ACCESS ANGLE ADJUSTMENT

*** : DIMENSIONS TO BE RESPECTED IN CASE OTHER MANUAL LEVERS ARE USED

Subject to technical modification without notice.

UNIVERSAL Pneumatic power clamp Ø50 / Ø63 mm sizes compatible

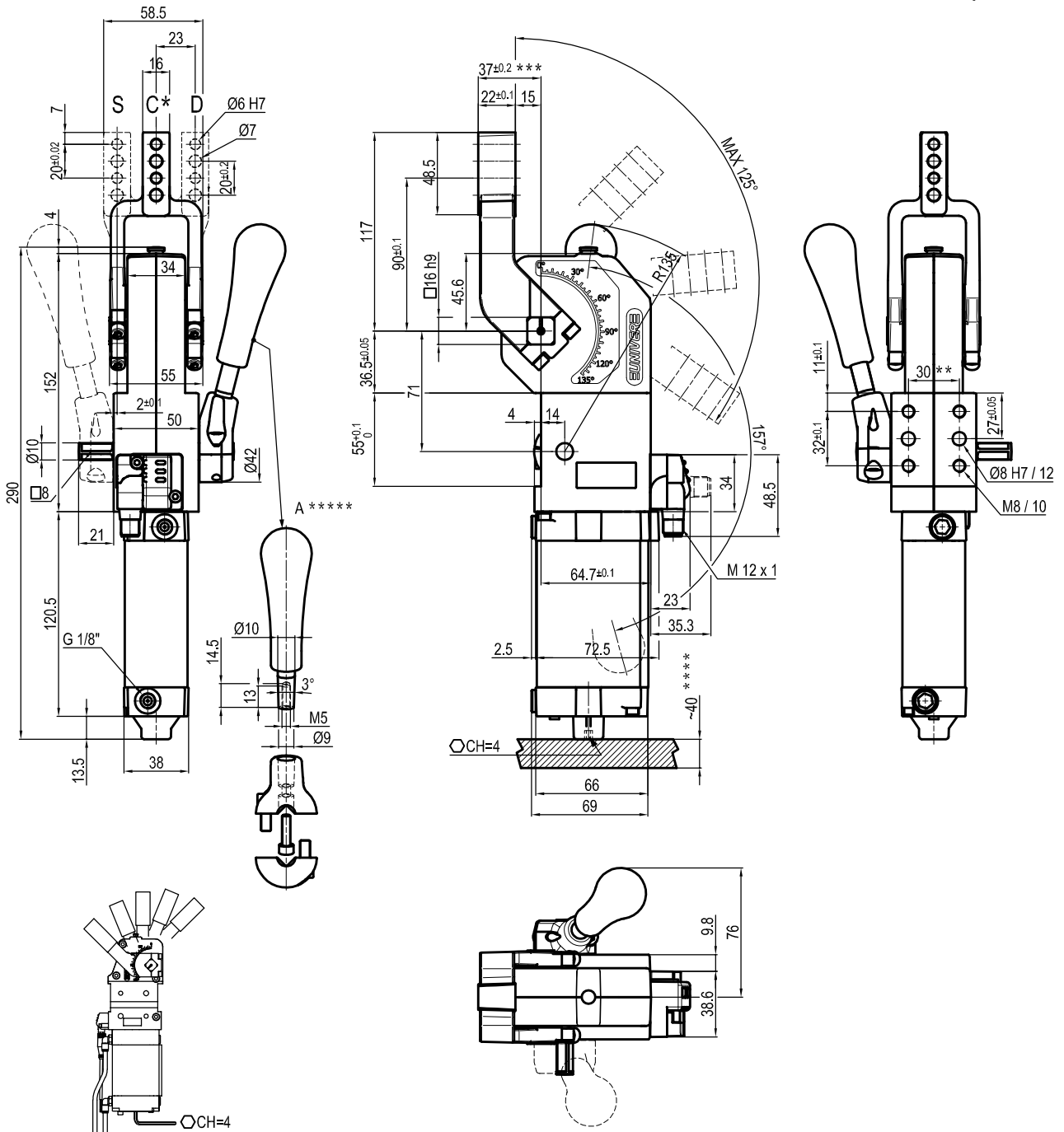

Bore Ø	Holding moment	Clamping moment	Weight (Clamping arm not included)
40 mm	600 Nm	170 Nm	2.1 Kg

Min./Max. operating pressure: **0,4 / 0,6 MPa**
 Operating temperature: **5° + 45° C**
 Opening angle: **adjustable from 0° to 125°**
 Horizontal arm mount position
 Electronic sensor with M12 swivel connector that can be orientated at 0° or 90°
 Supply voltage: 10±30 Vdc
 IP code: **IP 65**
 Pneumatic ports on both sides

* : "E" Ø50 / Ø63 mm SIZES COMPATIBLE
 ** : TOLERANCE BETWEEN DOWELS ± 0.02, TO SCREW HOLES ± 0.1
 *** : TOLERANCE AT 80 mm FROM PIVOT POINT
 **** : AREA TO ACCESS ANGLE ADJUSTMENT
 ***** : DIMENSIONS TO BE RESPECTED IN CASE OTHER MANUAL LEVERS ARE USED

Subject to technical modification without notice.

UNIVERSAL Pneumatic power clamp with manual lever arm at 45 mm from pivot point (arm style E-L-F)

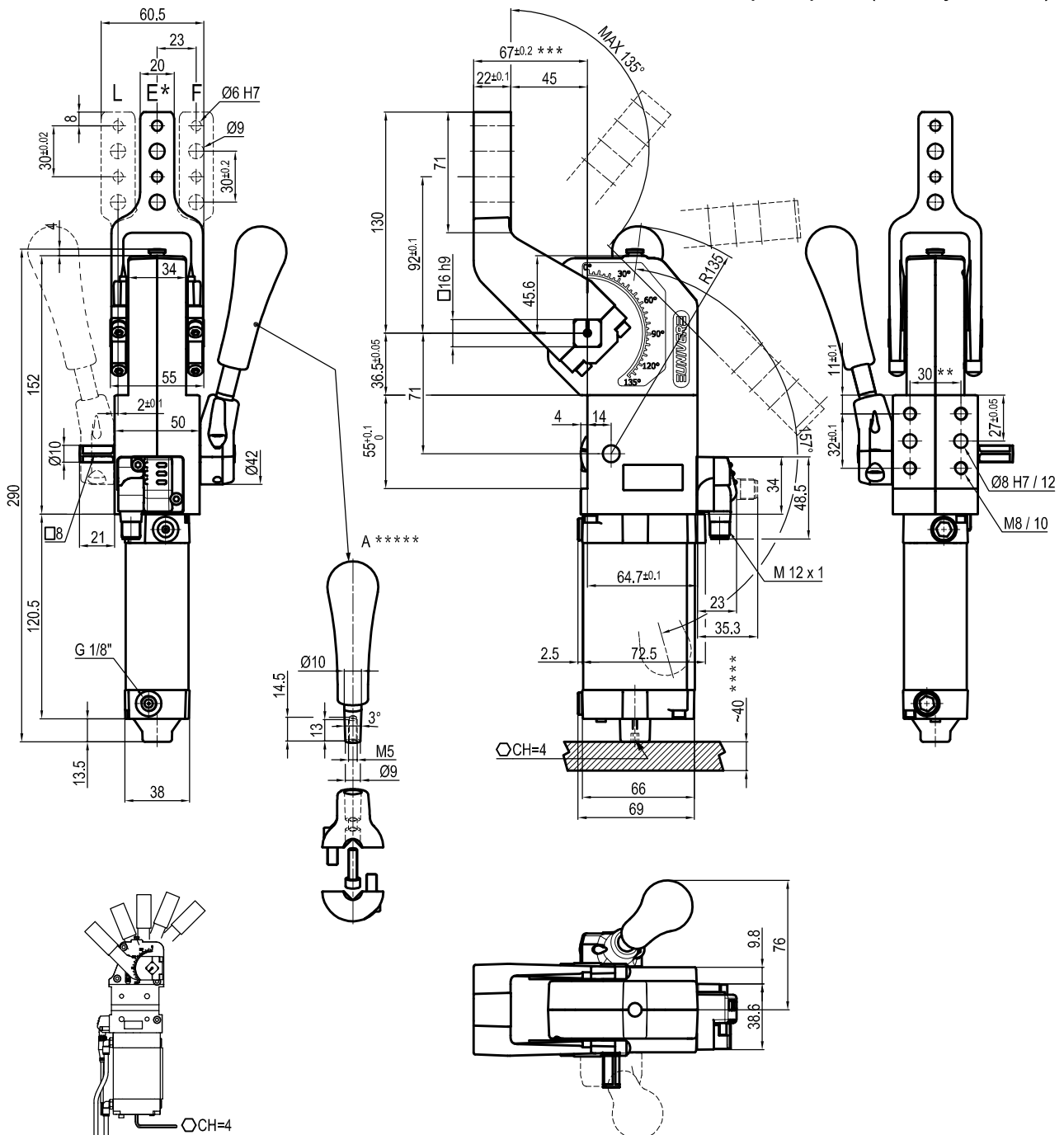

Bore Ø	Holding moment	Clamping moment	Weight (Clamping arm not included)
40 mm	600 Nm	170 Nm	2.1 Kg

Min./Max. operating pressure: **0,4 / 0,6 MPa**
 Operating temperature: **5° + 45° C**
 Opening angle: **adjustable from 0° to 135°**
 Horizontal arm mount position
 Electronic sensor with M12 swivel connector that can be orientated at 0° or 90°
 Supply voltage: 10±30 Vdc
 IP code: **IP 65**
 Pneumatic ports on both sides

* : "E" CENTRAL - Ø50 / Ø63 mm SIZES COMPATIBLE
 ** : TOLERANCE BETWEEN DOWELS ± 0.02, TO SCREW HOLES ± 0.1
 *** : TOLERANCE AT 80 mm FROM PIVOT POINT
 **** : AREA TO ACCESS ANGLE ADJUSTMENT

Subject to technical modification without notice.

UNIVERSAL Pneumatic power clamp Ø50 / Ø63 mm sizes compatible

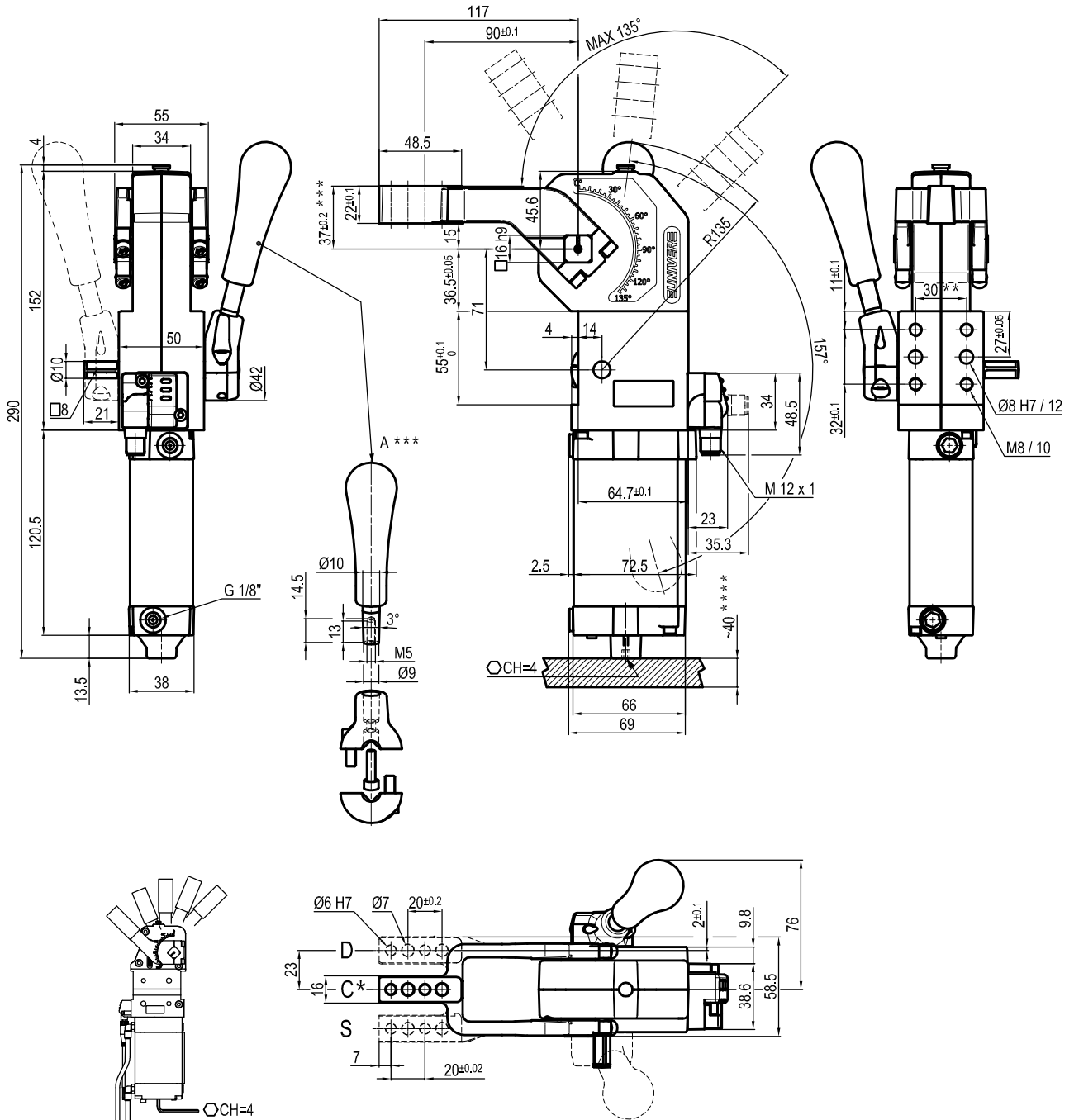

Bore Ø	Holding moment	Clamping moment	Weight (Clamping arm not included)
40 mm	600 Nm	170 Nm	2.1 Kg

Min./Max. operating pressure: **0,4 / 0,6 MPa**
 Operating temperature: **5° + 45° C**
 Opening angle: **adjustable from 0° to 135°**
 Vertical arm mount position
 Electronic sensor with M12 swivel connector that can be orientated at 0° or 90°
 Supply voltage: 10±30 Vdc
 IP code: **IP 65**
 Pneumatic ports on both sides

* : "E" CENTRAL - Ø50 / Ø63 mm SIZES COMPATIBLE
 ** : TOLERANCE BETWEEN DOWELS ± 0.02, TO SCREW HOLES ± 0.1
 *** : TOLERANCE AT 80 mm FROM PIVOT POINT
 **** : AREA TO ACCESS ANGLE ADJUSTMENT

Subject to technical modification without notice.

UNIVERSAL Pneumatic power clamp with manual lever arm at 45 mm from pivot point (arm style E-L-F)

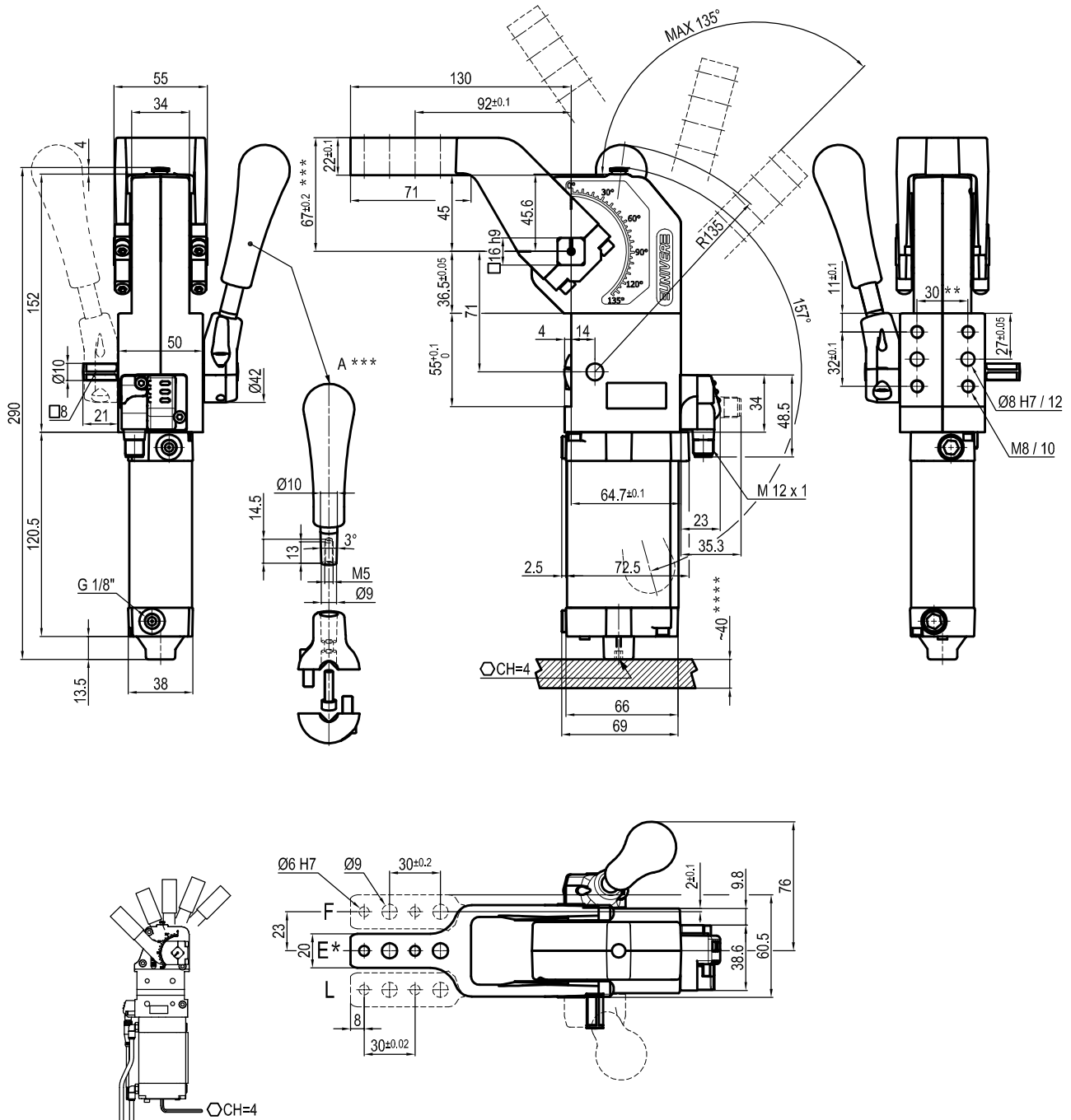

Bore Ø	Holding moment	Clamping moment	Weight (Clamping arm not included)
40 mm	600 Nm	170 Nm	2.1 Kg

Min./Max. operating pressure: **0,4 / 0,6 MPa**

Operating temperature: **5° + 45° C**

Opening angle: **adjustable from 0° to 135°**

Vertical arm mount position

Electronic sensor with M12 swivel connector that can be orientated at 0° or 90°

Supply voltage: 10÷30 Vdc

IP code: **IP 65**

Pneumatic ports on both sides

* : "E" CENTRAL - Ø50 / Ø63 mm SIZES COMPATIBLE

** : TOLERANCE BETWEEN DOWELS ± 0.02, TO SCREW HOLES ± 0.1

*** : TOLERANCE AT 80 mm FROM PIVOT POINT

**** : AREA TO ACCESS ANGLE ADJUSTMENT

Subject to technical modification without notice.